

PFLEGE + SICHERHEITSHINWEISE

AKKUSCHLOSS

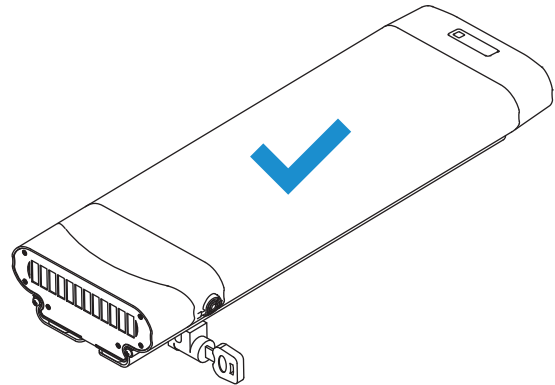

Keine großen und schweren Schlüsselanhänger anbringen.
Funktion von Schloss wird blockiert. Anhänger kann in Speicher gelangen!

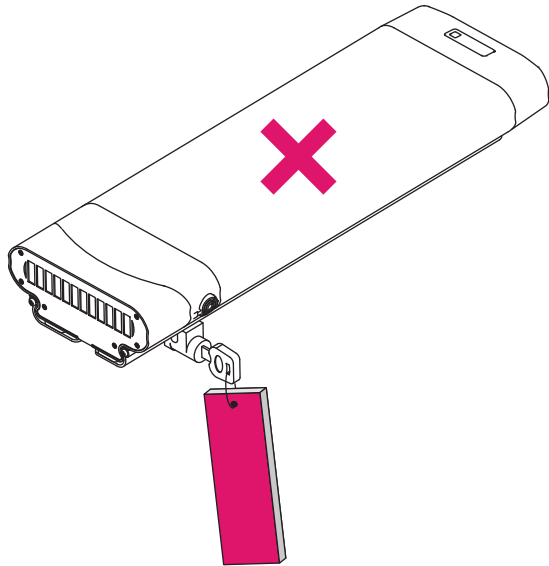
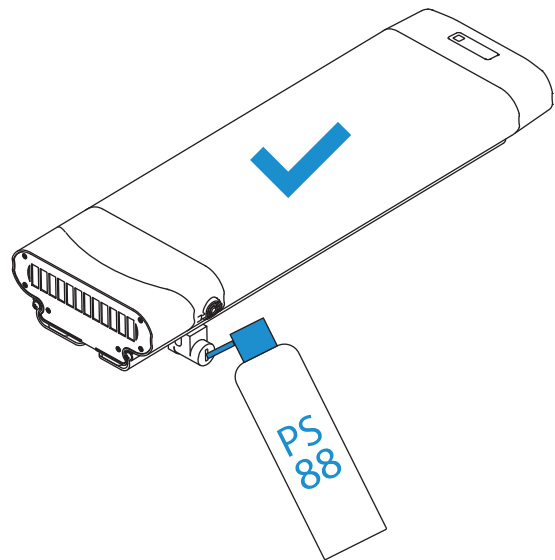
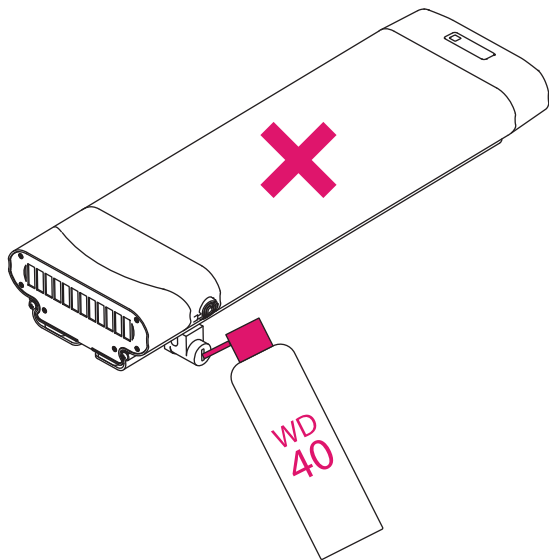

Schloss regelmäßig mit einem für Schlösser geeigneten Pflegespray, z.B. PS88 von ABUS pflegen.

Niemals WD40 verwenden da dadurch das Schloss verharzt und die sichere Funktion verlieren kann.

CARE + SAFETY INSTRUCTIONS

BATTERY LOCK

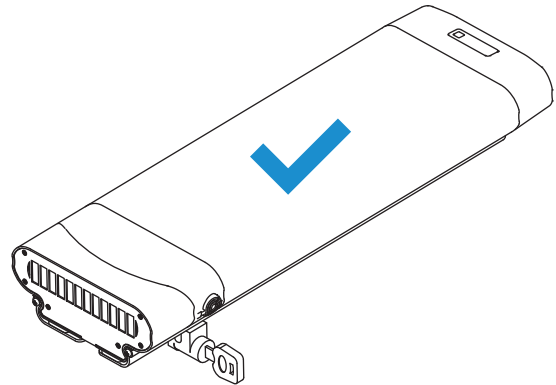
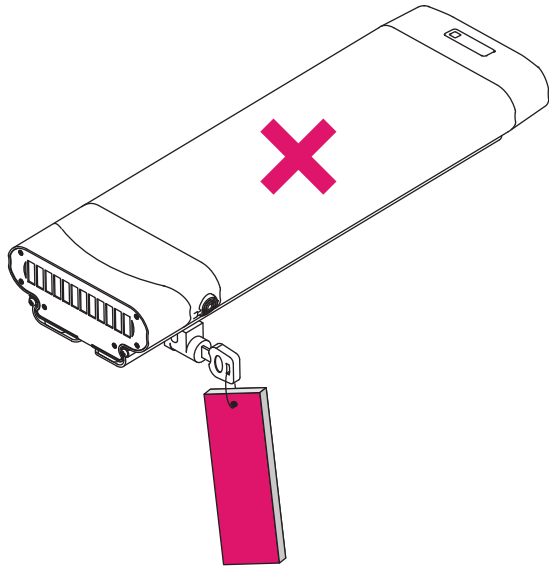

Do not attach large and heavy key rings! Function of lock can be blocked!
Key rings can get into spokes!

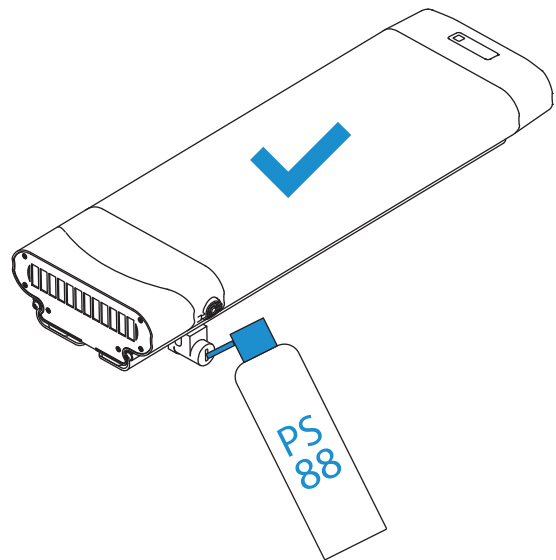
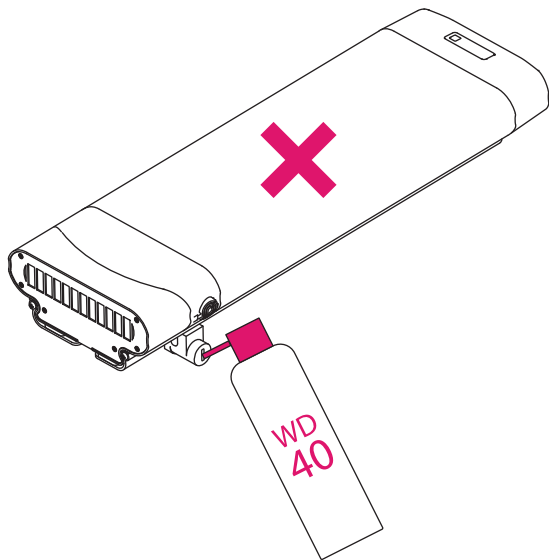

Maintain the lock regularly with a care spray suitable for locks, e.g. PS88 from ABUS.

Never use WD40 as this can cause the lock to jam and lose its secure function.